

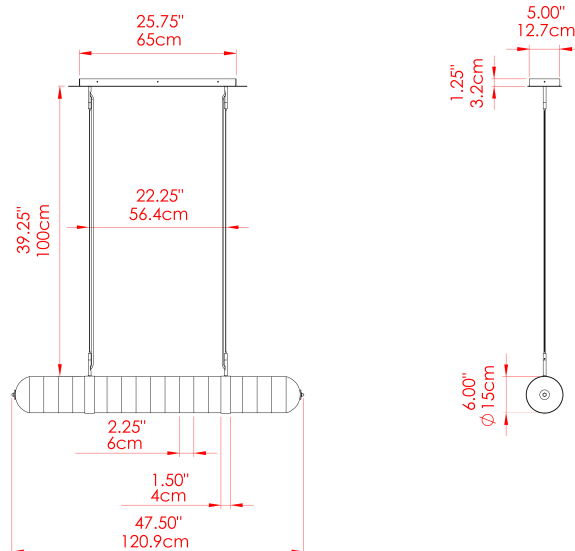

ASHFORD Pendant

MLP519ANTBRSPR Antique Brass



MATERIAL	Brass Steel Acrylic
HEIGHT	46.5"
WIDTH DIAMETER	6"
LENGTH PROJECTION	47.25"
WEIGHT	5.5 kg 12.3 lbs
LAMPHOLDER	E26
MAX WATTAGE	4W
VOLTAGE	110/120v
ENVIRONMENTAL RATING	Dry Location (IP20)
CLASS PROTECTION	Class I
SHADE	-
FLEX BAR CHAIN LENGTH	40"
CABLE TYPE	MLCA072 2 Core Round Brown Braid PVC UL

FIXING BRACKET: MLROSE27 | Antique Brass

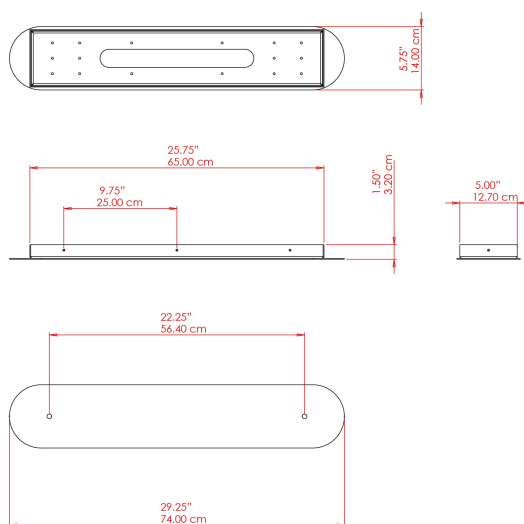

Product Notes:
1) Bulbs not included. 2) Dimensions do not include bulbs. 3) All products are individually made-to-order and therefore may differ slightly within manufacturing tolerances. 4) Cable / chain can be shortened during installation. Longer cable / chain lengths available on request. 5) Additional color finishes may be available on request. 6) Twisted cable is not available for UL wired products. Round cable in black or brown only is supplied instead. 7) Refer to our website for a full list of terms and conditions.





ASHFORD Pendant

MLP519ANTSLVPR Antique Silver

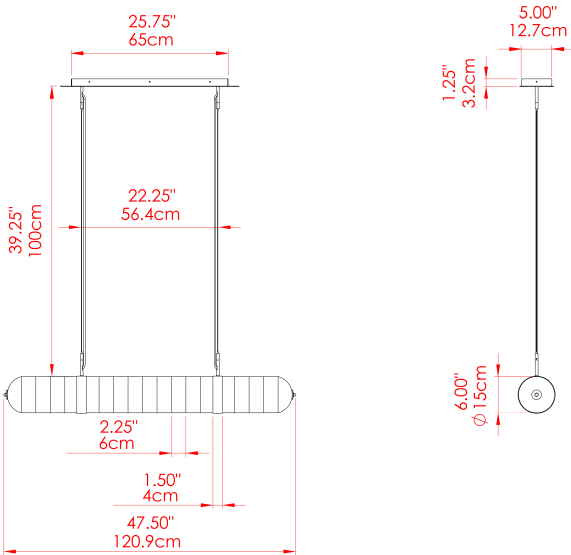

MATERIAL	Brass Steel Acrylic
HEIGHT	46.5"
WIDTH DIAMETER	6"
LENGTH PROJECTION	47.25"
WEIGHT	5.5 kg 12.3 lbs
LAMPHOLDER	E26
MAX WATTAGE	4W
VOLTAGE	110/120v
ENVIRONMENTAL RATING	Dry Location (IP20)
CLASS PROTECTION	Class I
SHADE	-
FLEX BAR CHAIN LENGTH	40"
CABLE TYPE	MLCA071 2 Core Round Black Braid PVC UL

FIXING BRACKET: MLROSE27 | Antique Silver

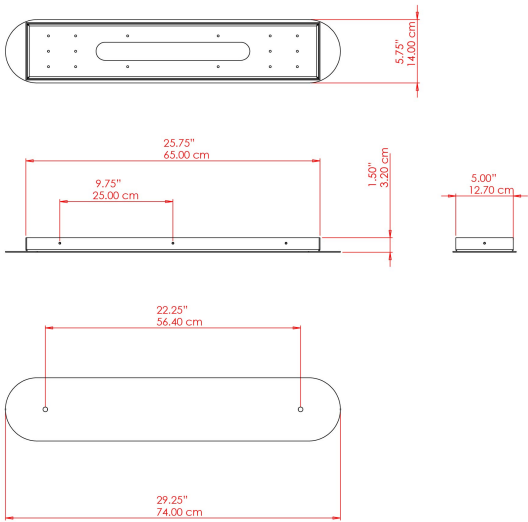

Product Notes:
1) Bulbs not included. 2) Dimensions do not include bulbs. 3) All products are individually made-to-order and therefore may differ slightly within manufacturing tolerances. 4) Cable / chain can be shortened during installation. Longer cable / chain lengths available on request. 5) Additional color finishes may be available on request. 6) Twisted cable is not available for UL wired products. Round cable in black or brown only is supplied instead. 7) Refer to our website for a full list of terms and conditions.





ASHFORD Pendant

MLP519POLBRSPR Polished Brass

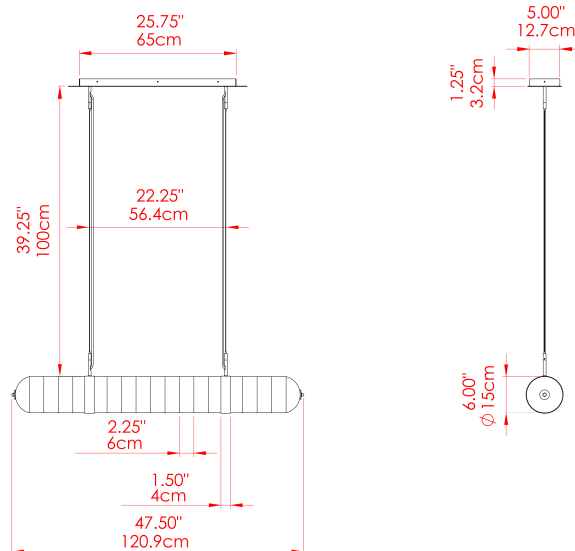

MATERIAL	Brass Steel Acrylic
HEIGHT	46.5"
WIDTH DIAMETER	6"
LENGTH PROJECTION	47.25"
WEIGHT	5.5 kg 12.3 lbs
LAMPHOLDER	E26
MAX WATTAGE	4W
VOLTAGE	110/120v
ENVIRONMENTAL RATING	Dry Location (IP20)
CLASS PROTECTION	Class I
SHADE	-
FLEX BAR CHAIN LENGTH	40"
CABLE TYPE	MLCA071 2 Core Round Black Braid PVC UL

FIXING BRACKET: MLROSE27 | Polished Brass

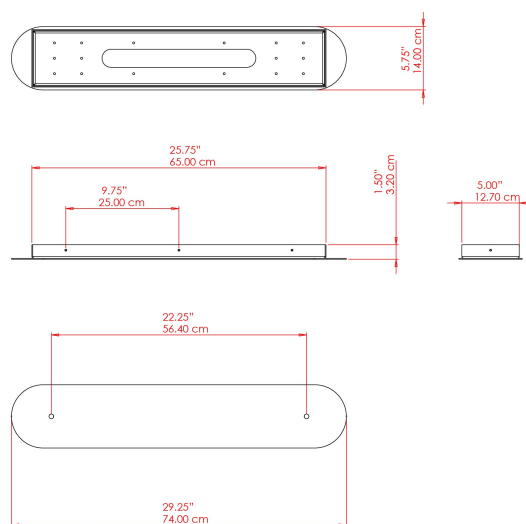

Product Notes:

1) Bulbs not included. 2) Dimensions do not include bulbs. 3) All products are individually made-to-order and therefore may differ slightly within manufacturing tolerances. 4) Cable / chain can be shortened during installation. Longer cable / chain lengths available on request. 5) Additional color finishes may be available on request. 6) Twisted cable is not available for UL wired products. Round cable in black or brown only is supplied instead. 7) Refer to our website for a full list of terms and conditions.





ASHFORD Pendant

MLP519SATBRSPR Satin Brass

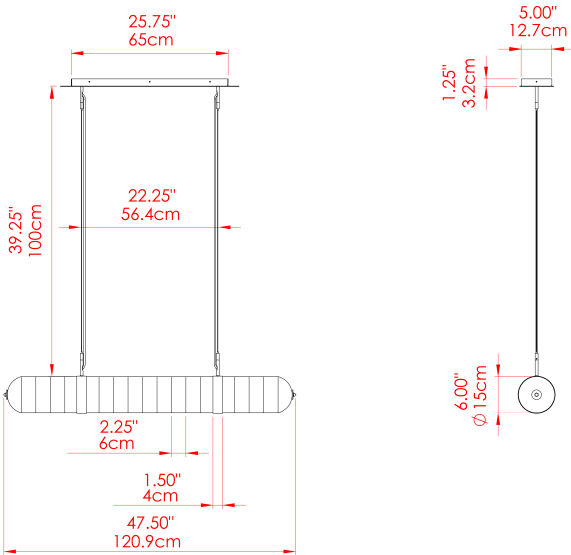

MATERIAL	Brass Steel Acrylic
HEIGHT	46.5"
WIDTH DIAMETER	6"
LENGTH PROJECTION	47.25"
WEIGHT	5.5 kg 12.3 lbs
LAMPHOLDER	E26
MAX WATTAGE	4W
VOLTAGE	110/120v
ENVIRONMENTAL RATING	Dry Location (IP20)
CLASS PROTECTION	Class I
SHADE	-
FLEX BAR CHAIN LENGTH	40"
CABLE TYPE	MLCA071 2 Core Round Black Braid PVC UL

FIXING BRACKET: MLROSE27 | Satin Brass

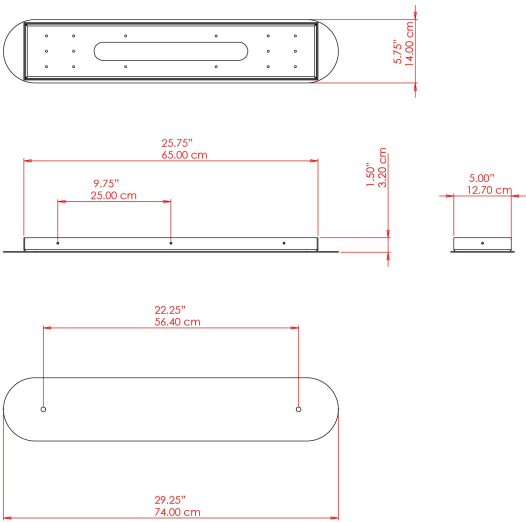

Product Notes:
1) Bulbs not included. 2) Dimensions do not include bulbs. 3) All products are individually made-to-order and therefore may differ slightly within manufacturing tolerances. 4) Cable / chain can be shortened during installation. Longer cable / chain lengths available on request. 5) Additional color finishes may be available on request. 6) Twisted cable is not available for UL wired products. Round cable in black or brown only is supplied instead. 7) Refer to our website for a full list of terms and conditions.





ASHFORD Pendant

MLP519PCMBKPR Matt Black

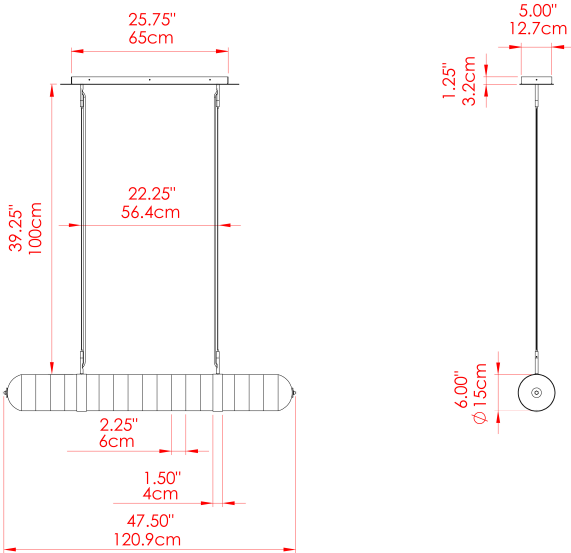

MATERIAL	Brass Steel Acrylic
HEIGHT	46.5"
WIDTH DIAMETER	6"
LENGTH PROJECTION	47.25"
WEIGHT	5.5 kg 12.3 lbs
LAMPHOLDER	E26
MAX WATTAGE	4W
VOLTAGE	110/120v
ENVIRONMENTAL RATING	Dry Location (IP20)
CLASS PROTECTION	Class I
SHADE	-
FLEX BAR CHAIN LENGTH	40"
CABLE TYPE	MLCA071 2 Core Round Black Braid PVC UL

FIXING BRACKET: MLROSE27 | Matte Black

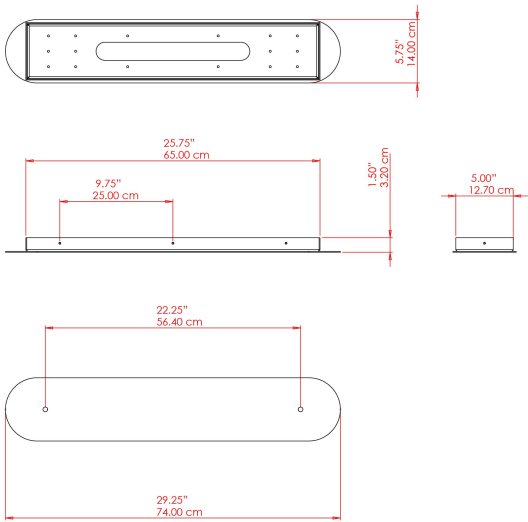

Product Notes:
1) Bulbs not included. 2) Dimensions do not include bulbs. 3) All products are individually made-to-order and therefore may differ slightly within manufacturing tolerances. 4) Cable / chain can be shortened during installation. Longer cable / chain lengths available on request. 5) Additional color finishes may be available on request. 6) Twisted cable is not available for UL wired products. Round cable in black or brown only is supplied instead. 7) Refer to our website for a full list of terms and conditions.

