

CAMBRIDGE Picture Light

MPL029ANTBRS Antique Brass

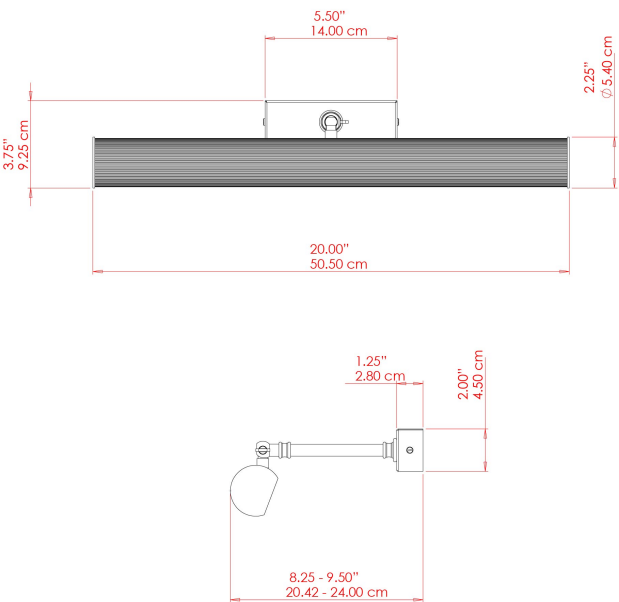

MATERIAL	Brass
HEIGHT	9.25 cm
WIDTH DIAMETER	50.5 cm
LENGTH PROJECTION	24 cm
WEIGHT	1 kg
LAMPHOLDER	G9
MAX WATTAGE	6.5W
VOLTAGE	220/240v
IP RATING	IP20
CLASS PROTECTION	Class I
SHADE	-
FLEX BAR CHAIN LENGTH	n/a
CABLE TYPE	-

FIXING BRACKET: MLWB06 | Antique Brass

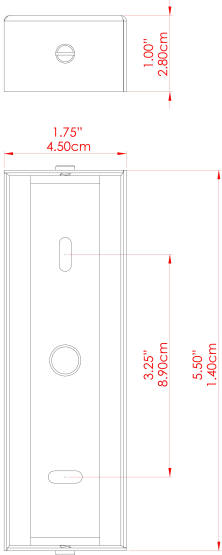

CAMBRIDGE Picture Light

MPL029ANTSLV Antique Silver

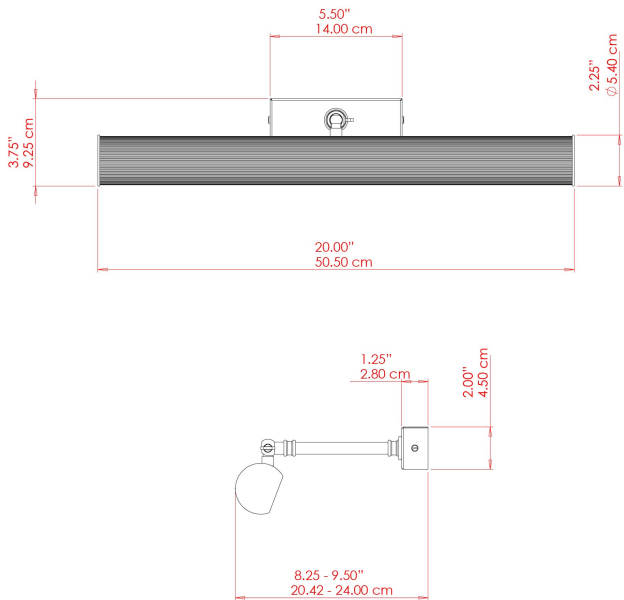

MATERIAL	Brass
HEIGHT	9.25 cm
WIDTH DIAMETER	50.5 cm
LENGTH PROJECTION	24 cm
WEIGHT	1 kg
LAMPHOLDER	G9
MAX WATTAGE	6.5W
VOLTAGE	220/240v
IP RATING	IP20
CLASS PROTECTION	Class I
SHADE	-
FLEX BAR CHAIN LENGTH	n/a
CABLE TYPE	-

FIXING BRACKET: MLWB06 | Antique Silver

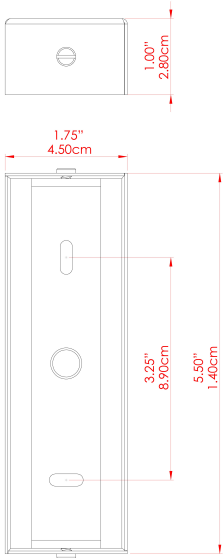

CAMBRIDGE Picture Light

MPL029PCBLK Black

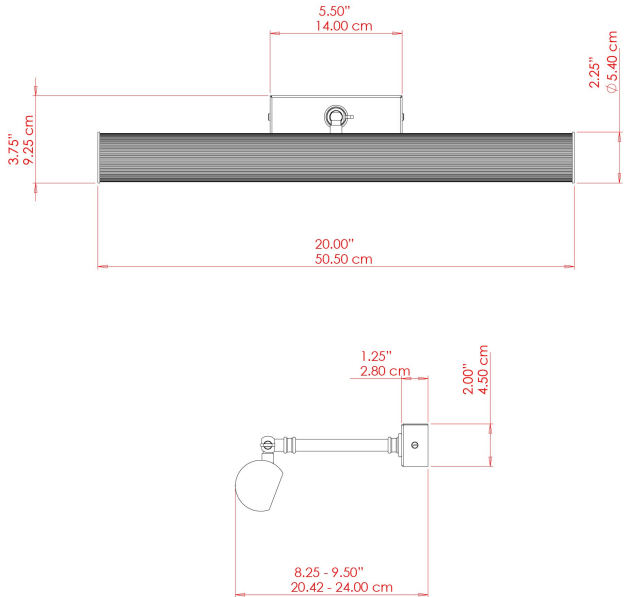

MATERIAL	Brass
HEIGHT	9.25 cm
WIDTH DIAMETER	50.5 cm
LENGTH PROJECTION	24 cm
WEIGHT	1 kg
LAMPHOLDER	G9
MAX WATTAGE	6.5W
VOLTAGE	220/240v
IP RATING	IP20
CLASS PROTECTION	Class I
SHADE	-
FLEX BAR CHAIN LENGTH	n/a
CABLE TYPE	-

FIXING BRACKET: MLWB06 | Gloss Black

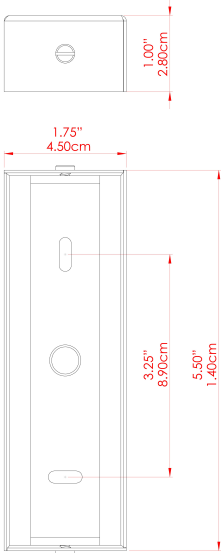

CAMBRIDGE Picture Light

MPL029PCMBK Matt Black

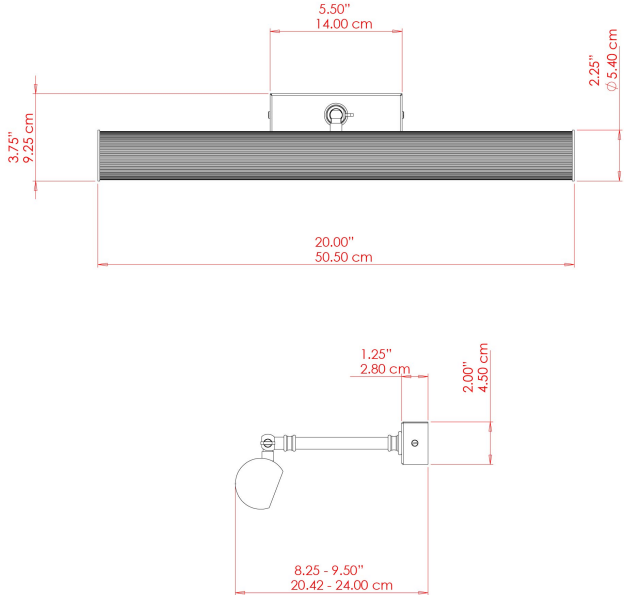

MATERIAL	Brass
HEIGHT	9.25 cm
WIDTH DIAMETER	50.5 cm
LENGTH PROJECTION	24 cm
WEIGHT	1 kg
LAMPHOLDER	G9
MAX WATTAGE	6.5W
VOLTAGE	220/240v
IP RATING	IP20
CLASS PROTECTION	Class I
SHADE	-
FLEX BAR CHAIN LENGTH	n/a
CABLE TYPE	-

FIXING BRACKET: MLWB06 | Matt Black

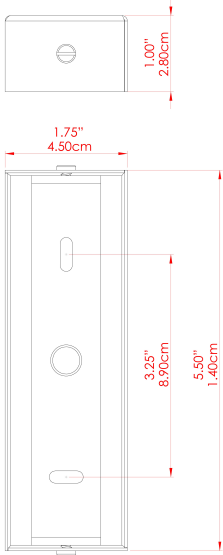

CAMBRIDGE Picture Light

MPL029POLBRS Polished Brass

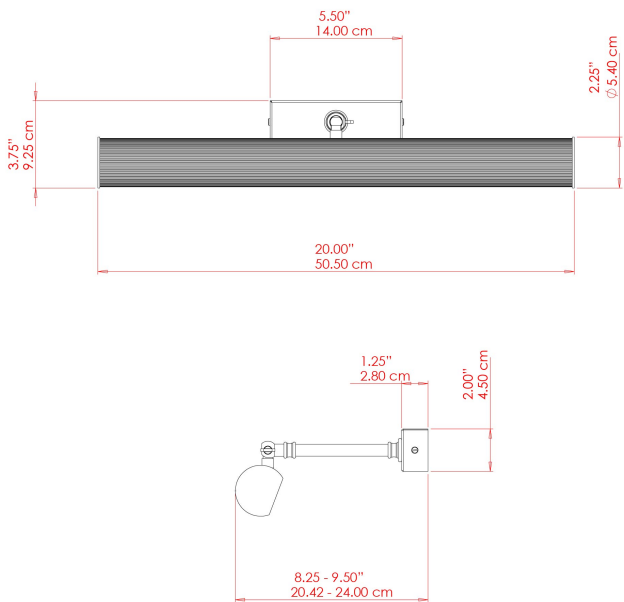

MATERIAL	Brass
HEIGHT	9.25 cm
WIDTH DIAMETER	50.5 cm
LENGTH PROJECTION	24 cm
WEIGHT	1 kg
LAMPHOLDER	G9
MAX WATTAGE	6.5W
VOLTAGE	220/240v
IP RATING	IP20
CLASS PROTECTION	Class I
SHADE	-
FLEX BAR CHAIN LENGTH	n/a
CABLE TYPE	-

FIXING BRACKET: MLWB06 | Polished Brass

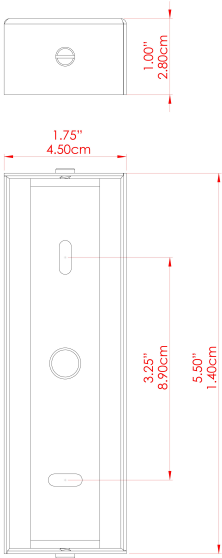

CAMBRIDGE Picture Light

MPL029SATBRS Satin Brass

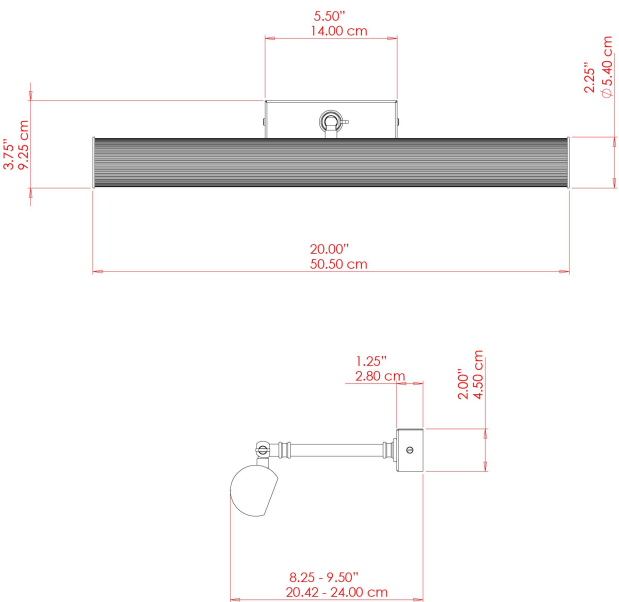

MATERIAL	Brass
HEIGHT	9.25 cm
WIDTH DIAMETER	50.5 cm
LENGTH PROJECTION	24 cm
WEIGHT	1 kg
LAMPHOLDER	G9
MAX WATTAGE	6.5W
VOLTAGE	220/240v
IP RATING	IP20
CLASS PROTECTION	Class I
SHADE	-
FLEX BAR CHAIN LENGTH	n/a
CABLE TYPE	-

FIXING BRACKET: MLWB06 | Satin Brass

